

TECNOVIDEO

CCTV SYSTEMS AND ACCESSORIES

EX129 SERIES

EXPLOSION PROOF CAMERA HOUSING

HAZARDOUS AREA

- ATEX/IECEX/UKCA/INMETRO EXPLOSION PROOF CAMERA HOUSING
- AISI316L STAINLESS STEEL CONSTRUCTION
- SUITABLE FOR ANALOG AND IP CAMERAS
- CERTIFICATION TEMPERATURE -40°C +60°C (+75°C PEAK)
- INTEGRATED WIPER VERSION AVAILABLE
- WEATHERPROOF STANDARD IP66/IP67
- OPTIONAL BUILT-IN FIBER MEDIA CONVERTER
- OPTIONAL BUILT-IN 115VAC OR 230VAC POWER SUPPLIES



TECHNICAL SPECIFICATIONS

GENERAL & MECHANICAL

Dimensions	See drawings next page	
Operating Temperature	-40° +60°C, +75°C peak (-40°F +140°F, +167°F peak)	
Construction	AISI316L Stainless Steel	
Finish	Electro-polished	
Mounting	4x M5 on 101,6 PCD, 4x M6 on 90x130	
Cable entries	2x M25x1,5 cable entries	
Wiper	Yes	
Weight		
Model	Unit [kg]	Package [kg]
EX129-C25*	10	11
EX129-C2M	12	13
EX129-C2L	13,5	14,5
EX129WR-C2M	12,5	13,5
EX129WR-C2L	14	15

* SHORT size available upon request

ELECTRICAL

Thermostatically controlled heater	T[°C] ON = 12 ± 4°C, T[°C] OFF = 20 ± 3°C
Available voltages	24VAC, 115VAC, 230VAC (+/-10%). PoE available on request
Max power consumption	25W

CERTIFICATIONS

Ingress Protection Rating	EN 60529 (IP66/IP67) ⊕II 2 G Ex db op pr IIC T6 Gb -40°C ≤ Tamb ≤ +60°C ⊕II 2 D Ex tb IIIC T85°C Db -40°C ≤ Tamb ≤ +60°C ⊕II 2 G Ex db op pr IIB T5 Gb -40°C ≤ Tamb ≤ +75°C ⊕II 2 D Ex tb IIIC T100°C Db -40°C ≤ Tamb ≤ +75°C
ATEX/UKEX Standards	EN60079-0; EN60079-1; EN60079-28; EN60079-31
IECEX Standards	IEC60079-0; IEC60079-1; IEC60079-28; IEC60079-31
INMETRO	ABNT NBR IEC 60079-0; ABNT NBR IEC 60079-1; ABNT NBR IEC 60079-28; ABNT NBR IEC 60079-31
EMC	EN50130-4; EN55035; EN/IEC61000-6-2; EN/IEC61000-6-4
LVD	EN 60950-1; EN 60950-22
RoHS	2011/65/EU + 2015/863/EU (RoHS 3)
WEEE	2012/19/EU

MODELS

EX129-C2M/24	Fixed housing, MEDIUM size, with sunshield and 24VAC/DC heater
EX129-C2L/24	Fixed housing, LONG size, with sunshield and 24VAC/DC heater
EX129WR-C2M/24	Fixed housing, MEDIUM size, with sunshield, heater, telemetry receiver and wiper, 24VAC
EX129WR-C2L/24	Fixed housing, LONG size, with sunshield, heater, telemetry receiver and wiper, 24VAC
EX129-C2M/115	Fixed housing, MEDIUM size, with sunshield and 115VAC heater
EX129-C2L/115	Fixed housing, LONG size, with sunshield and 115VAC heater
EX129WR-C2M/115	Fixed housing, MEDIUM size, with sunshield, heater, wiper, telemetry receiver and power supply, 115VAC
EX129WR-C2L/115	Fixed housing, LONG size, with sunshield, heater, wiper, telemetry receiver and power supply, 115VAC
EX129-C2M/230	Fixed housing, MEDIUM size, with sunshield and 230VAC heater
EX129-C2L/230	Fixed housing, LONG size, with sunshield and 230VAC heater
EX129WR-C2M/230	Fixed housing, MEDIUM size, with sunshield, heater, wiper, telemetry receiver and power supply, 230VAC
EX129WR-C2L/230	Fixed housing, LONG size, with sunshield, heater, wiper, telemetry receiver and power supply, 230VAC

Usable front window diameter: 75 mm (toughened glass).

SHORT size available upon request.

PRE-ASSEMBLED CONDUIT TAILS

EXACCTF3-A	3 meters armored composite cable tail (power, Ethernet, data) with 2x M25 barrier nickel plated brass glands
EXACCTF3-C	3 meters armored composite cable tail (power, data, fiber optic) with 2x M25 barrier nickel plated brass glands. Fiber termination: SC
EXACCTF5-A	5 meters armored composite cable tail (power, Ethernet, data) with 2x M25 barrier nickel plated brass glands
EXACCTF5-C	5 meters armored composite cable tail (power, data, fiber optic) with 2x M25 barrier nickel plated brass glands. Fiber termination: SC
EXACCTF10-A	10 meters armored composite cable tail (power, Ethernet, data) with 2x M25 barrier nickel plated brass glands
EXACCTF10-C	10 meters armored composite cable tail (power, data, fiber optic) with 2x M25 barrier nickel plated brass glands. Fiber termination: SC

ACCESSORIES

SSBK-M	Wall mounting bracket
SSPM-M	Pole mount adapter for SSBK-M
SSPTM-M	Top pole mount adapter
PSU01	Power supply 230VAC/24VAC installed in the camera housing
PSU02	Power supply 115-230VAC/12VDC installed in the camera housing
SPL01	PoE+ Splitter installed in the camera housing

DIMENSIONS

FRONT VIEW

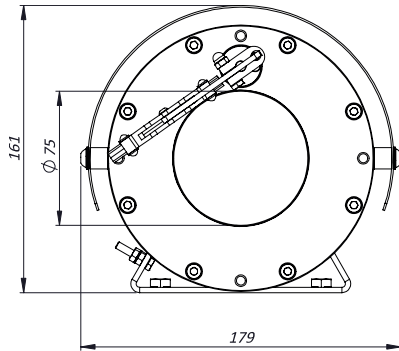

SIDE VIEW

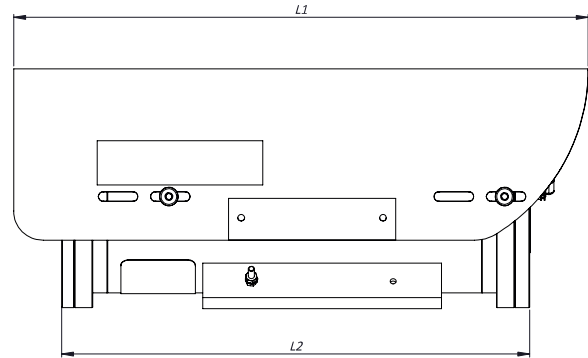

MOUNTING PATTERN

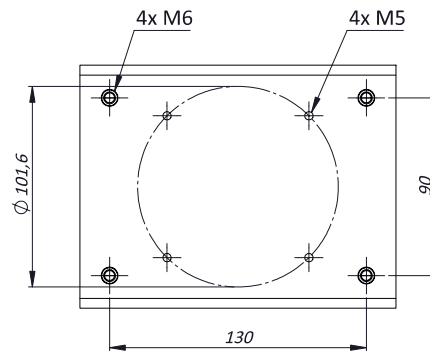

MAX EXTERNAL LENGTH

Model	L1 [mm]	L2 [mm]
EX129/EX129-C2S	385	314
EX129-C2M/EX129WR-C2M	510	436
EX129-C2L/EX129WR-C2L	630	560

MAX INTERNAL USABLE AREA

Model	Max internal dimensions [mm]	Max usable internal diameter [mm]
EX129-C2S	80x80x160	95
EX129-C2M	80x80x280	95
EX129-C2L	80x80x405	95
EX129WR-C2M	80x80x185	85
EX129WR-C2L	80x80x310	85

Please contact us if bigger cameras/zoom lenses are needed.