

TECNOVIDEO

CCTV SYSTEMS AND ACCESSORIES

EX129IR SERIES

EXPLOSION PROOF HOUSING FOR THERMAL CAMERAS

- ATEX/IECEX/UKCA/INMETRO CAMERA HOUSING FOR HAZARDOUS LOCATIONS
- AISI316L STAINLESS STEEL CONSTRUCTION
- GERMANIUM OR SAPPHIRE WINDOW VERSION (LWIR or MWIR/SWIR THERMAL CAMERAS)
- GRIDLESS GERMANIUM WINDOW VERSION AVAILABLE (LWIR)
- CERTIFICATION TEMPERATURE -40°C +75°C
- OPTIONAL BUILT-IN FIBER MEDIA CONVERTER
- OPTIONAL BUILT-IN 230VAC POWER SUPPLY
- WEATHERPROOF STANDARD IP66/IP67
- FOR ANALOG OR IP CAMERAS



TECHNICAL SPECIFICATIONS

GENERAL & MECHANICAL

Dimensions	See drawings next page	
Operating Temperature	-40° +60°C, +75°C peak (-40°F +140°F, +167°F peak)	
Construction	AISI316L Stainless Steel	
Finish	Electro-polished	
Window	Germanium HC coated or Sapphire	
Mounting	See drawings next page	
Cable entries	2x M25x1,5 cable entries	

Weight Model	Unit [kg]	Package [kg]
EX129IR-SW-C2S	11	12
EX129IR-SW-C2M	12,5	13,5
EX129IR-SW-C2L	14	15
EX129IR-C2S/EX129IRS-C2S	10	11
EX129IR-C2M/EX129IRS-C2M	12	13
EX129IR-C2L/EX129IRS-C2L	13,5	14,5

ELECTRICAL

Thermostatically controlled heater	T[°C] ON = 12 ± 4°C, T[°C] OFF = 20 ± 3°C
Available voltages	24VAC, 230VAC (+/-10%) PoE available upon request
Max power consumption	25W

CERTIFICATIONS

Ingress Protection Rating	EN 60529 (IP66/IP67) ⊕ II 2 G Ex db op pr IIC T6 Gb -40°C ≤ Tamb ≤ +60°C ⊕ II 2 D Ex tb IIIC T85°C Db -40°C ≤ Tamb ≤ +60°C ⊕ II 2 G Ex db op pr IIB T5 Gb -40°C ≤ Tamb ≤ +75°C ⊕ II 2 D Ex tb IIIC T100°C Db -40°C ≤ Tamb ≤ +75°C
ATEX/UKEX Standards	EN 60079-0; EN 60079-1; EN 60079-28; EN 60079-31
IECEX Standards	IEC 60079-0; IEC 60079-1; IEC 60079-28; IEC 60079-31
INMETRO	ABNT NBR IEC 60079-0; ABNT NBR IEC 60079-1; ABNT NBR IEC 60079-28; ABNT NBR IEC 60079-31
EMC	EN 50130-4; EN 55035; EN/IEC 61000-6-2; EN/IEC 61000-6-4
LVD	EN 60950-1; EN 60950-22
RoHS	2011/65/EU + 2015/863/EU (RoHS 3)
WEEE	2012/19/EU

MODELS

EX129IR-C2S/24	Fixed camera housing, SHORT size, with Germanium window with protective grid, 24VAC/DC heater
EX129IR-C2M/24	Fixed camera housing, MEDIUM size, with Germanium window with protective grid, 24VAC/DC heater
EX129IR-C2L/24	Fixed camera housing, LONG size, with Germanium window with protective grid, 24VAC/DC heater
EX129IRS-C2S/24	Fixed camera housing, SHORT size, with Sapphire window with protective grid for MWIR thermal cameras, 24VAC/DC heater
EX129IRS-C2M/24	Fixed camera housing, MEDIUM size, with Sapphire window with protective grid for MWIR thermal cameras, 24VAC/DC heater
EX129IRS-C2L/24	Fixed camera housing, LONG size, with Sapphire window with protective grid for MWIR thermal cameras, 24VAC/DC heater
EX129IR-SW-C2S/24	Fixed camera housing, SHORT size, with Gridless Germanium window, 24VAC/DC heater
EX129IR-SW-C2M/24	Fixed camera housing, MEDIUM size, with Gridless Germanium window, 24VAC/DC heater
EX129IR-SW-C2L/24	Fixed camera housing, LONG size, with Gridless Germanium window, 24VAC/DC heater

Suffix /230 is used for 230VAC models. All models include sunshield and heater

- Usable front window diameter: 50 mm (Germanium with Hard Carbon Coating)
- Usable front window diameter: 50 mm (Sapphire)
- Usable front window diameter: 50 mm (GRIDLESS Germanium with Hard Carbon Coating)

*Gridless version patented by TECNOVIDEO

Available upon request: Built-in Single mode Fiber Optic media converter

EXPLOSION PROOF HOUSING FOR THERMAL CAMERAS**PRE-ASSEMBLED CONDUIT/CABLE TAILS**

EXACCTF3-A	3 meters armored composite cable tail (power, Ethernet, data) with 2x M25 barrier nickel plated brass glands.
EXACCTF3-C	3 meters armored composite cable tail (power, data, fiber optic) with 2x M25 barrier nickel plated brass glands. Fiber termination: SC
EXACCTF5-A	5 meters armored composite cable tail (power, Ethernet, data) with 2x M25 barrier nickel plated brass glands.
EXACCTF5-C	5 meters armored composite cable tail (power, data, fiber optic) with 2x M25 barrier nickel plated brass glands. Fiber termination: SC
EXACCTF10-A	10 meters armored composite cable tail (power, Ethernet, data) with 2x M25 barrier nickel plated brass glands.
EXACCTF10-C	10 meters armored composite cable tail (power, data, fiber optic) with 2x M25 barrier nickel plated brass glands. Fiber termination: SC

MOUNTING ACCESSORIES

SSBK-M	AISI316L wall mounting bracket
SSPM-M	AISI316L pole mount adapter for SSBK-M
SSPTM-M	AISI316L top pole mount adapter
PSU01	Power supply 230VAC/24VAC installed inside the camera housing
PSU02	Power supply 115-230VAC/12VDC installed inside the camera housing
SPL01	PoE+ Splitter installed inside the camera housing

EX129IR DIMENSIONS

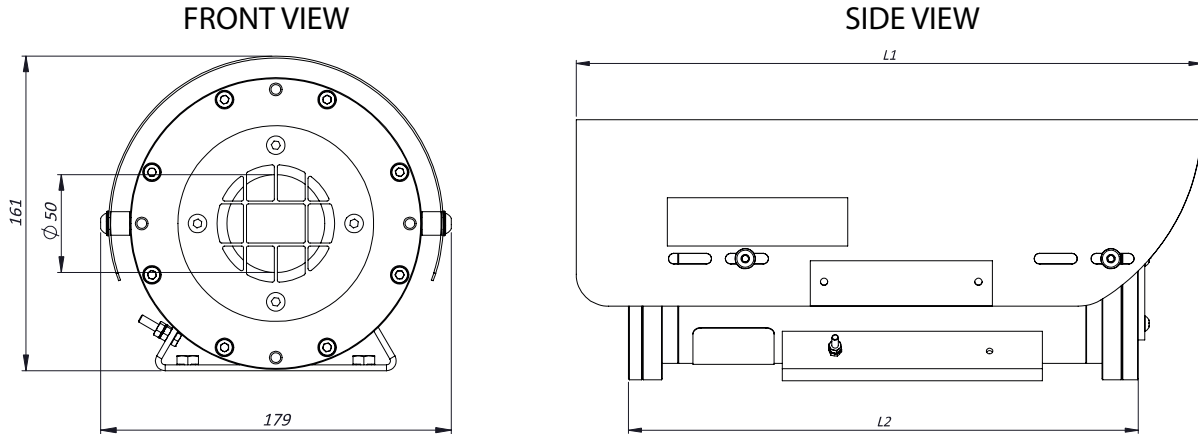

MOUNTING PATTERN

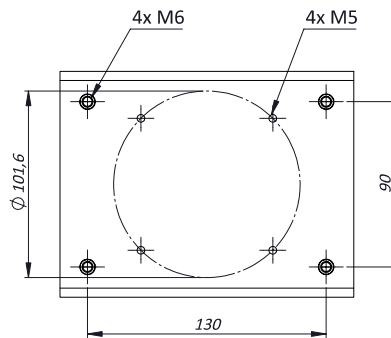

MAX EXTERNAL LENGTH

Model	L1 [mm]	L2 [mm]
EX129IR-C2S/EX129IRS-C2S	385	311
EX129IR-C2M/EX129IRS-C2M	510	434
EX129IR-C2L/EX129IRS-C2L	630	557

MAX INTERNAL USABLE AREA

Model	Max internal dimensions [mm]	Max usable internal diameter [mm]
EX129IR-C2S/EX129IRS-C2S	80x80x160	95
EX129IR-C2M/EX129IRS-C2M	80x80x283	95
EX129IR-C2L/EX129IRS-C2L	80x80x406	95

Please contact us if bigger cameras/zoom lenses are needed.

Please contact us in case the camera dimensions are near to the max internal usable dimension in order to develop a custom fitting solution.

EX129IR-SW DIMENSIONS

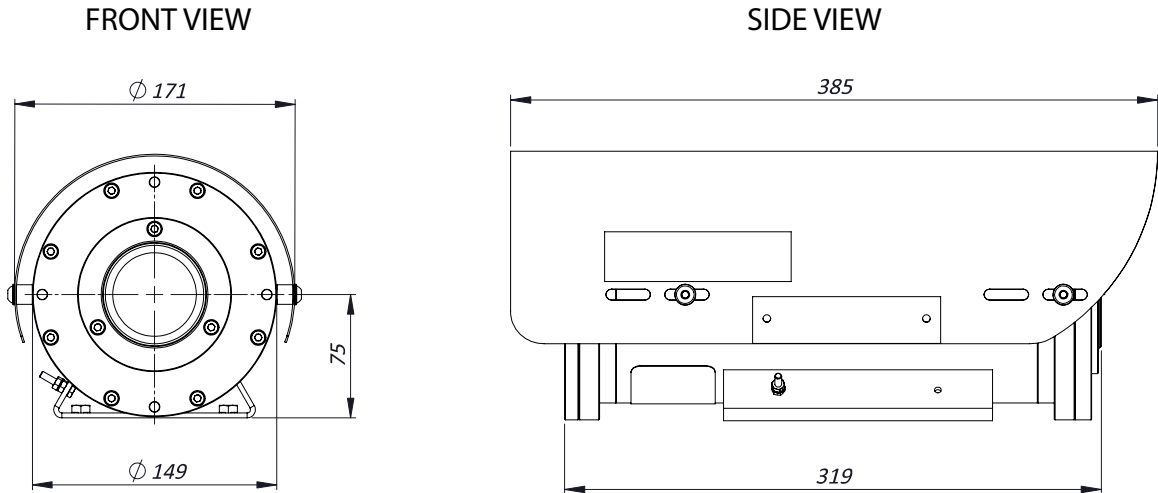

MOUNTING PATTERN

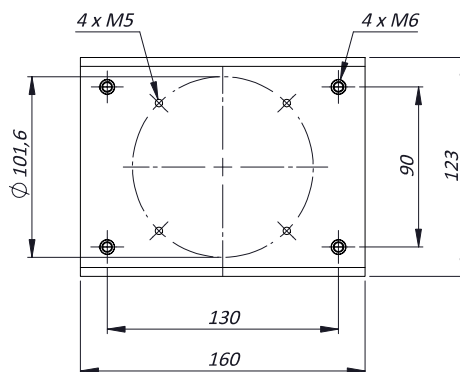

MAX EXTERNAL LENGTH

Model	L1 [mm]	L2 [mm]
EX129IR-SW-C2S	385	319
EX129IR-SW-C2M	510	442
EX129IR-SW-C2L	630	565

MAX INTERNAL USABLE AREA

Model	Max internal dimensions [mm]	Max usable internal diameter [mm]
EX129IR-SW-C2S	80x80x162	95
EX129IR-SW-C2M	80x80x285	95
EX129IR-SW-C2L	80x80x408	95

Please contact us if bigger cameras/zoom lenses are needed.

Please contact us in case the camera dimensions are near to the max internal usable dimension in order to develop a custom fitting solution.