

# TECNOVIDEO

CCTV SYSTEMS AND ACCESSORIES

# SAF118TV2 SERIES

TUNNEL CAMERA STATION

SAFE AREA

- SPECIFICALLY DESIGNED FOR TUNNEL INSTALLATIONS
- 3MP CAMERA, 30FPS, 33x AUTOFOCUS OPTICAL ZOOM
- AISI316L STAINLESS STEEL CONSTRUCTION
- ELONGATED FRONT TUBE PROTECTION
- DIRT RESISTANT WINDOW WITH SPECIAL COATING
- 3-AXIS WALL/CEILING MOUNTING BRACKET
- WEATHERPROOF STANDARD IP66/IP67
- POE AVAILABLE

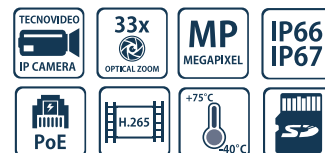

ONVIF<sup>®</sup> G S T

## TECHNICAL SPECIFICATIONS

### GENERAL & MECHANICAL

<b>Dimensions</b>	See drawings next page
<b>Operating Temperature</b>	-40°C +60°C, +75°C peak (-40°F +140°F, +167°F peak)
<b>Construction</b>	AISI316L Stainless Steel
<b>Finish</b>	Electro-polished
<b>Window</b>	Dirt resistant glass with coating on both sides
<b>Mounting</b>	See drawings next page
<b>Cable entries</b>	2 M20x1,5 nickel plated brass cable glands (included) Standard cable diameter 5-10mm
<b>Weight</b>	5 kg

### ELECTRICAL

<b>Thermostatically controlled heater</b>	<b>T[°C] ON</b> = 12 ± 4°C, <b>T[°C] OFF</b> = 20 ± 3°C
<b>Available voltages</b>	24 VAC, 230 VAC (+/-10%), POE
<b>Power consumption</b>	25W

### VIDEO/CAMERA

<b>Sensor</b>	1/2.8" Progressive CMOS, 3MP
<b>Compression</b>	H.264/H.265/M-JPEG
<b>Streaming</b>	Up to 4 configurable streams
<b>Resolution</b>	Up to 2065x1553 @30fps
<b>Frame Rate</b>	30 fps
<b>Iris</b>	P-Iris, Auto-Iris
<b>Sensitivity</b>	Color: 0.04 lux, B/W: 0.002 lux
<b>Shutter Speed</b>	1~1/10000 s
<b>Optical Filter</b>	Automatically removable IR-cut filter
<b>White Balance</b>	Contrast White Balance
<b>Dynamic range</b>	WDR/Multi Exposure HDR
<b>Image settings</b>	Color, Brightness, Sharpness, Contrast, White Balance, Exposure control, 2DNR/3DNR/NR by motion masking
<b>Event Triggers</b>	External Input, Analytics, Network Failure Detection, Periodical Event, Manual Trigger
<b>Event Actions</b>	External Output Activation
<b>Analytics</b>	Motion Detection/ Tampering/ Audio detection
<b>Lens</b>	33x Optical Zoom, 10x Digital Zoom, AF, 4.6-152mm, F1.6
<b>Local Storage</b>	microSD (card not provided)
<b>Network Storage</b>	support for recording to NAS

### NETWORK

<b>Interface</b>	10/100 Mbps Ethernet
<b>Security</b>	User Authentication/ HTTPS/ IP Filter/ IEEE 802.1x/SNMPv3
<b>ONVIF Protocols</b>	ONVIF profile G/S/T compliant IPv4/v6, TCP, UDP, RTP, RTSP, HTTP, HTTPS, ICMP, FTP, SMTP, DHCP, PPPoE, UPnP, IGMP, SNMPv1-3, QoS, ARP, NTP

### CERTIFICATIONS

<b>Ingress Protection (EN 60529)</b>	IP66/IP67
<b>EMC</b>	EN 50130-4; EN/IEC 61000-6-2; EN/IEC 61000-6-4
<b>LVD</b>	EN 60950-1; EN 60950-22
<b>RoHS</b>	2011/65/EU + 2015/863/EU (RoHS 3)
<b>WEEE</b>	2012/19/EU

### MODELS

<b>SAF118TV2/24</b>	Camera station with 3-axis wall mount and heater, 24VAC
<b>SAF118TV2/230</b>	Camera station with 3-axis wall mount and heater, 230VAC
<b>SAF118TV2/POE</b>	Camera station with 3-axis wall mount and heater, PoE

### ACCESSORIES

<b>SSPM-S</b>	Pole mount adapter.
<b>SK118</b>	Sunshield kit for SAF118TV2 series camera station (for installation outside tunnels)

[www.tecnovideocctv.com](http://www.tecnovideocctv.com)

Tecnovideo S.r.l. - Via A. De Gasperi, 3 36030 Villaverla (VI) ITALY - Tel. +39.0445.350444 - [info@tecnovideocctv.com](mailto:info@tecnovideocctv.com)

## TUNNEL CAMERA HOUSING

### DIMENSIONS

FRONT VIEW

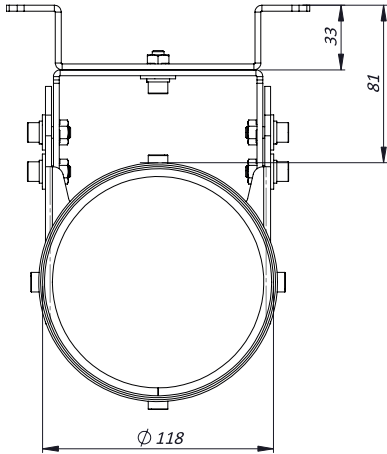

SIDE VIEW

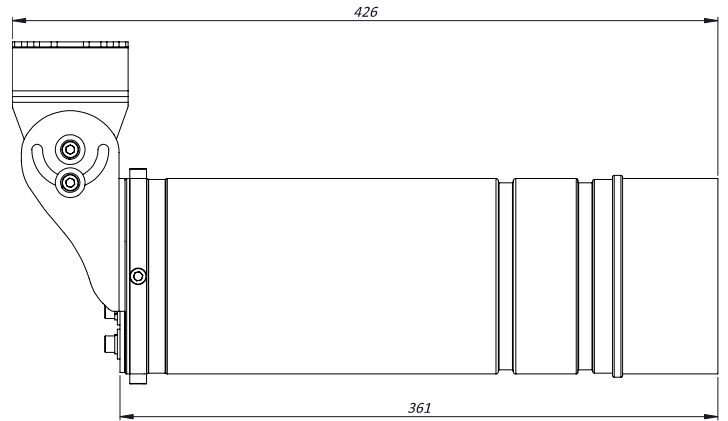

MOUNTING PATTERN

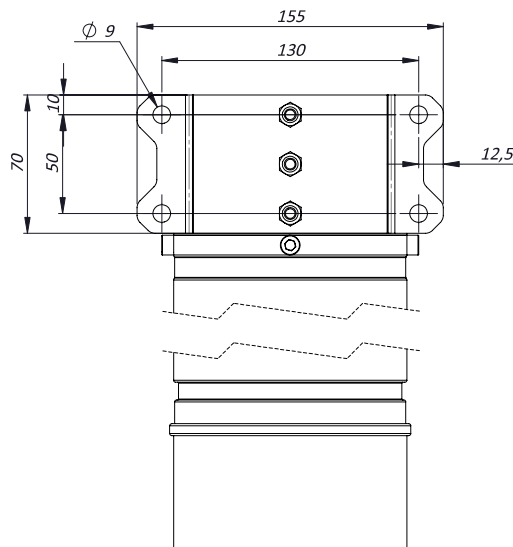

MAX EXTERNAL LENGTH

Model	L1 [mm]	L2 [mm]
SAF118TV2/24	426	361
SAF118TV2/230	426	361
SAF118TV2/POE	426	361